

Fold-away lift DH-RM.25

2000 - 2500 Kg



DHOLLANDIA





Mounting with floor extension plate added behind the rear sill of the vehicle



Flush mount with floor plate integrated inside the vehicle body

Powerful robust fold-away lift adapted to the harshest winter conditions (level-ride, auto tilt at ground level)

The DH-RM.25 is DHOLLANDIA's **most powerful** fold-away tail lift. The long 1600 mm full-aluminium platform offers 1500-2500 kg lift capacity, and is specially adapted to offer **maximum reliability in the harshest winter conditions** , incl. **Power-Down** operation.

The DH-RM.25 is usually mounted underneath a reinforced bed extension plate with **2 sturdy dock-bumpers** and adjustable ladders. But it can also be mounted flush with the rear sill of the vehicle body. The fold-away storage of this lift is ideal for operations **needing frequent access to loading docks**. The optional bumper OAF105 is compatible with most common **Dock-Lock vehicle restraint systems** .

This tail lift is primarily designed for heavy-duty trucks and semi-trailers. A walk-ramp kit is available as an option [OAM054].

- + Available with POWER-DOWN function, and arctic oil (-51°C). Suitable for the coldest winter temperatures.
- + Lift frame in hot-dip zinc plated or "galvanised" finish. Best possible protection against corrosion [OAT104].





2 lift cylinders for maximum platform stability.
Very heavy-duty floor extension plate with height-adjustable side steps and rubber dock buffers

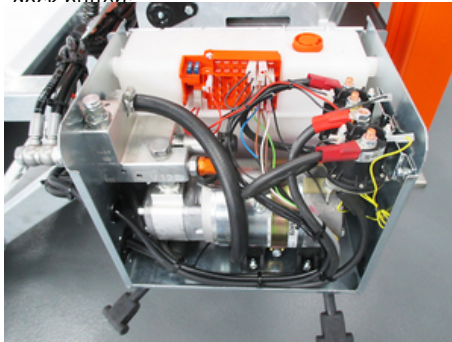

Power-down operation (double acting descend) with double starter solenoid [OAH025.2]

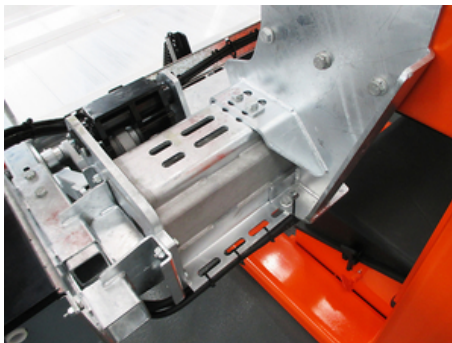

Bolt-on mounting plates for quick and easy fitting [OAM010]

PLATFORM

- Reinforced full aluminium platform (base section + foldable point)
- The folding and unfolding of the platform are assisted by powerful torsion springs

FUNCTIONAL & MECHANICAL CHARACTERISTICS

- Conical / wedge platform. Level ride with automatic tilt at ground level
- Fixed stabiliser rods, platform orientation is only adjustable during installation
- 3-piece bumper bar, compatible with DOCK-LOCK vehicle restraint system for loading docks, available as option [OAF105]. Patented.

HYDRAULICAL CHARACTERISTICS

- 2 lift cylinders for maximum platform stability
- Power-down (double acting descend) available as an option [OAH025.1]
- Lift cylinders protected by rubber gaitors and steel plates against chippings
- Cylinder piston rods in hard-chromed stainless steel
- Electrical safety valves on all cylinders
- Manual emergency operation on all electrovalves
- Robust pump unit 12V or 24V DC mounted at the side of the lift frame

ELECTRICAL CHARACTERISTICS

- Arctic exterior control box with IP67 rated sealed contacts, and a main battery isolator switch with removable key [OAE041.BP]
- Electrical controls without sensitive electronic components
- Safe exterior controls with compulsory 2-hand operation
- Electric motor with thermal cut-out fuse

FITTING

- Bolt-on mounting plates for quick and easy fitting [OAM010]
- Heavy-duty floor plate (vehicle bed extension plate) available as option [OAM041]
- 2 sturdy dock-bumpers with height-adjustable ladders available as option [OAM042.LR]

FINISH & MAINTENANCE

- Low-maintenance bearings in all articulation points, plus grease nipples
- Lift frame in hot-dip zinc plated or "galvanised" finish. Best possible protection against corrosion [OAT104].
- Alu platform or platform sections in natural finish

Disclaimer: data and images of lifts and options are indicative, and may vary in function of the lift execution and vehicle details. Ask confirmation from DHOLLANDIA.



Tail lift with standard bumper bar in 3 sections



Tail lift with articulated bumper bar for Dock-Lock applications (option)



TECHNICAL CHARACTERISTICS

DH-RM.25

Lift frame	150 x 150 mm
Cylinders	2 double acting lift cylinders (power down) + 2 fixed stabilisers
Type of ride	Wedged platform, level ride with automatic tilt at ground level
Platform material	Alu / Alu
Standard platform depths	1600 mm
Standard platform widths	- 2150 mm for 2430 mm wide extension plate - 2300 mm for 2590 mm wide extension plate
Lift arm lengths	920 mm
Lift arm widths	1400 mm
Mounting	- Heavy-duty N-A bed extension plate [option OAM041] - 2 sturdy dock-bumpers with adjustable ladders [OAM042]
Standard control unit	OAE041.BP arctic control box
Standard finish of the lift frame	Hot-dip zinc plated finish [OAT104]

MOUNTING DIMENSIONS

DH-RM.25

larm		920
K max.		1520
K min.		1200
CT max.		745
CT std.		650
COT max.		800
M	at CT max.	990
M	at CT min.	1070
V max.		1600

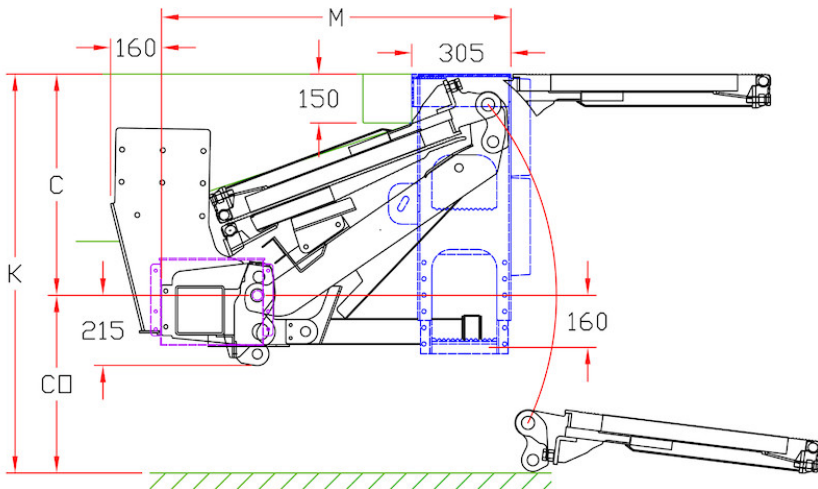



OAE001 - 2-button wander lead with spiral cable



OAE015.PR - 2 function toggle switch control (principal control)



OAE015.O - 2 function toggle switch control (option)



OAE041.BP.0 - Arctic push-button control box + main battery isolator switch (+ push button)

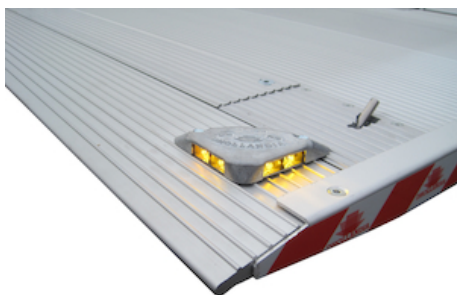

OAE200 - Flashing platform lights

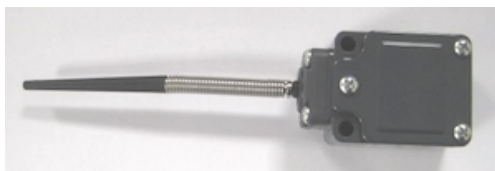

OAE213 - Limit switch E0387 (supplied loose)

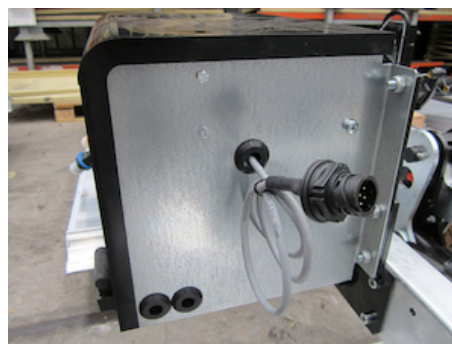

OAE500 - VEHH plug connection for dashboard switch

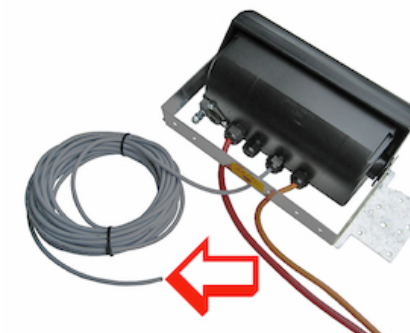

OAE501.12 - VEHH wire connection for dashboard switch 12 m



OAE503.1 - Cabin switch (single use)



OAE503.2 - Cabin / dashboard switch



OAF100.ST - Fixed 3-piece bumper in steel, mounted to the lift frame



OAF105 - Hinged bumper DH-RM.25 for Dock-Lock





OAH001 - Winter oil -30°C

OAH002 - Arctic winter oil -52°C

OAH025.1 - POWER DOWN function + 1 starter solenoid

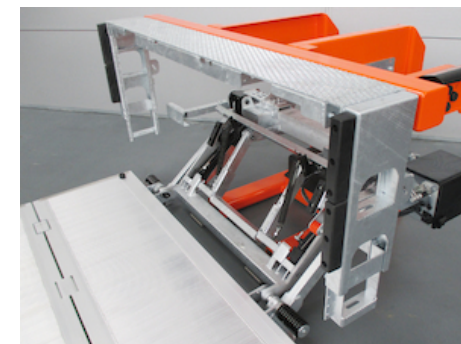

OAM041 - Bed extension plate RM25 (N-A)

OAM042.LR - 2 side ladders L+R for OAM041

OAM046.1 - Mounting bar lift cylinders DH-R*

OAM053 - Widening blocs for bed extension L+R

OAM054 - Walk-ramp kit for DH-R*



OAM057.LR - 2 side ladders L+R for OAM041_051 (flex)

OAP100.M - 2-piece symm. roll-stops in the platform point - MANUAL

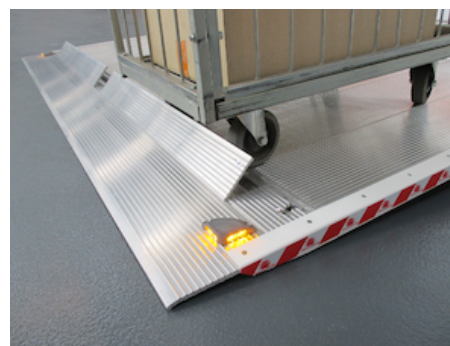

OAP100.A - 2-piece symm. roll-stops in the platform point - AUTOMATIC



OAT020 - Reflecting platform flags type TÜV



OAT023 - Reflecting platform flags type Export Red



OAU100 - Control box on L side (R steering wheel for UK)



OAP601 - Fixed part of folding platform in ALU instead of steel

