

Column lift DH-VXA.10.E9

750 - 1000 Kg



DHOLLANDIA



Intermediate lift for loading dock heights up to 1.9 m high

The DH-VXA.10.E9 is a **full-aluminium** column lift (aluminium platform; alu columns and lift runners).

The construction with **2 tilt-cylinders** is designed to operate longer platforms and allows to tilt the platform to different angles other than the 90° horizontal or open position.

The lift system incorporates the facility to **elevate the platform above the loading floor** of the vehicle, so that it becomes possible for lower vehicles to get quick and direct access to higher loading docks and thus speed up loading / unloading.



PLATFORM

- Light-weight aluminium platform with fixed leading edge
- Fixed leading edge at outboard platform edge [hinged ramps available as an option]
- Inboard platform edge is equipped with toe-guard profile and safety switch

FUNCTIONAL & MECHANICAL CHARACTERISTICS

- VX lift system: lift driven by 1 lift cylinder mounted vertically in the right side column, plus steel cable(s) crossing at roof level for the actuation of the left side lift runner
- Lift system equipped with mechanical Load Safety Device (steel cable rupture device)
- Lifting height in function of the vehicle height
- Lifting height above cargo floor of the body. Therefore suitable for loading / unloading at higher loading docks
- Flat platform, level ride

HYDRAULICAL CHARACTERISTICS

- 1 single acting lift cylinder
- Hydraulic closure. 2 single acting tilt cylinders, positioned vertically [OVH002.0]
- The platform orientation is adjustable by means of the tilt cylinders
- Robust pump unit 12V or 24V DC, supplied loose for mounting on the vehicle chassis
- Electrical safety valves on all cylinders

ELECTRICAL CHARACTERISTICS

- Exterior control box with main battery disconnect switch and removable key [OAE030.BT.0]
- Electrical controls without sensitive electronic components
- Safe exterior controls with compulsory 2-hand operation
- Electric motor with thermal cut-out fuse

FITTING

- Aluminium lift columns with bolt-on fitting to the rear frame of the vehicle body
- CE-conforming toe-guard to be built by the body builder at the outboard edge of the loading floor(s). Advice available at DHOLLANDIA

FINISH & MAINTENANCE

- Alu platform or platform sections in natural finish
- Not included in basic configuration: roof construction, loading floor extension; toe-guard protection at the end of the loading floor; and guard rails

Disclaimer: data and images of lifts and options are indicative, and may vary in function of the lift execution and vehicle details. Ask confirmation from DHOLLANDIA.



TECHNICAL CHARACTERISTICS**DH-VXA.10.E9**

Lift system	1 lift cylinder mounted vertically in the right side column, plus a steel cable crossing at roof level for the actuation of the left side lift runner
Open / close	<ul style="list-style-type: none">- 2 tilt cylinders, vertically mounted- The platform orientation is adjustable at any position from the exterior controls
Type of ride	Flat platform, level ride
Standard lift system	<ul style="list-style-type: none">- Flat platform with fixed leading edge- Roll-stops & hinged ramps available as an option
Material	Light-weight aluminium platform
Standard platform depths	<ul style="list-style-type: none">- 1800 - 2000 mm- Other platform sizes on request
Standard control unit	OAE030.BT
Standard finish of the lift frame	Aluminium lifting mechanism

MOUNTING DIMENSIONS**DH-VXA.10.E9**



OAE030.BT.0 - Exterior joystick control box + main battery isolator switch (+ turn switch)



OAE001 - 2-button wander lead with spiral cable



OVE001 - 2-button wander lead + long spiral cable



OVE003.L - Female plug mounted on platform LEFT side

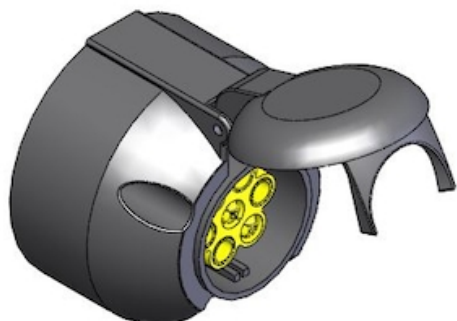

OVE003.R - Female plug mounted on platform RIGHT side



OVE006.L - 4-button foot controls mounted LEFT side



OVE006.R - 4-button foot controls mounted RIGHT side



OAE031.Z.0 - 3+1 button exterior control box without main battery isolator switch



OAM026 - Mounting support type B for OAE031.Z



OAE038.A - Main battery isolator switch with demountable key

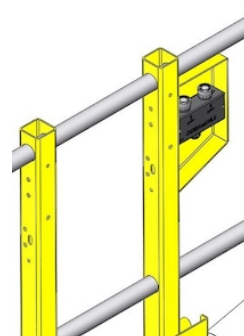

OVE150.L - Toggle-switch up / down control on LEFT-side guard rail



OVE150.R - Toggle-switch up / down control on RIGHT-side guard rail



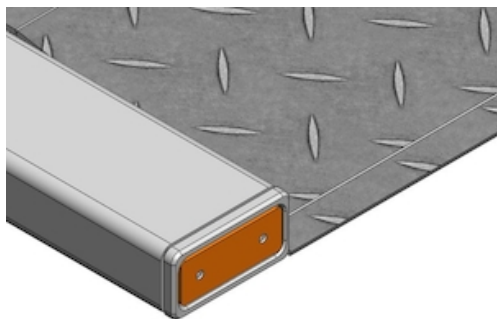

OVE201.A - Platform lights IN the platform tubes

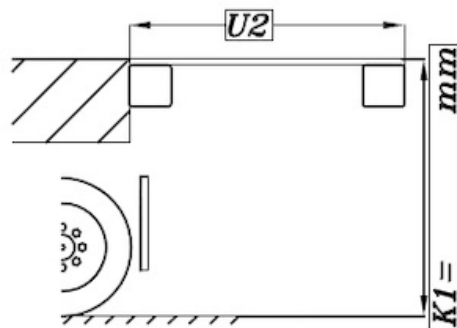

OVF055.B - Extension vehicle floor between columns (level 0)



OVP002.0 - Aluminium platform on DH-V* lift

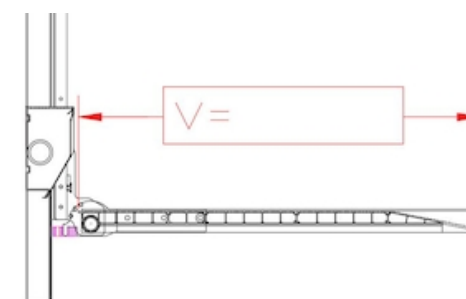

OVP012.A - Extension of aluminium platform per 100 mm

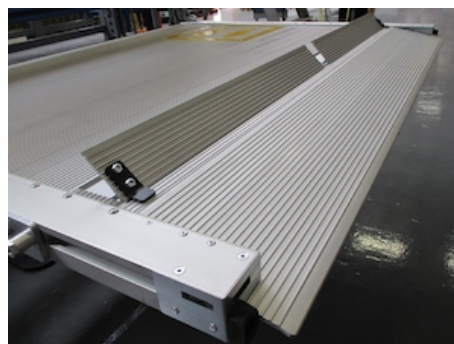

OVP100.A - 2 automatic rollstops in profile before point

OVP100.M - 2 manual rollstops in profile before point



OVP120.S.R - 2 hinged ramps in steel at rear edge of platform



OVP120.A.R - 2 hinged ramps in aluminium at rear edge of platform

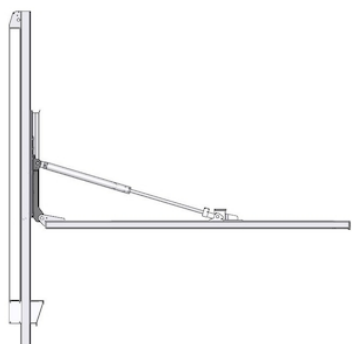

OVP300 - Platform supplied without safety rails

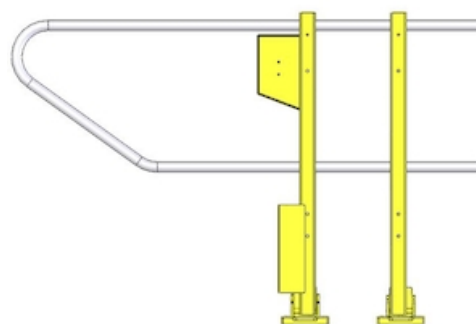

OVP301 - 2 hinged side safety rails L+R - STD

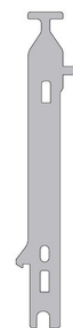

OVP309 - Lock for safety rail on platform surface

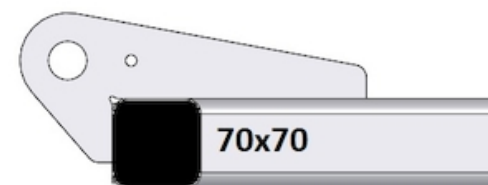

OVP400 - Platform without toe-guard flap

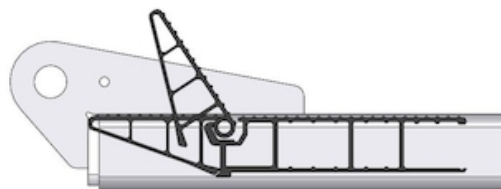

OVP401.1 - Alu toe-guard flap + safety switch (K1-K9)

OVH002.0 - Tilt cylinders mounted vertically (std.)

OVH006.10 - Downward platform inclination to -10°

OVH006 - Inclination of platform to the ground (-45°)

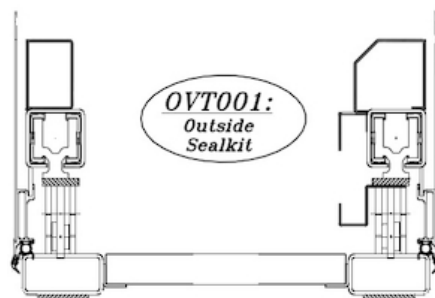
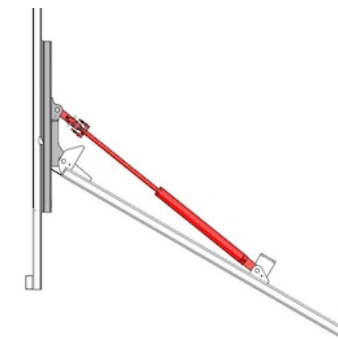

OVH110 - Double acting flow valve V189 open/close

OVT001 - Shrouds + platform seals mounted at the outside of the lift columns



OVT110 - Aluminium profiles of the DH-V* platform in anodised finish



OAT020 - Reflecting platform flags type TÜV



OAT023 - Reflecting platform flags type Export Red

