

# Side-mounted slider lift DH-SOZ.10 750 - 1000 Kg



**DHOLLANDIA**



## Compact slider lift for use at the side doors

The DH-SOZ.10 replaces the fold-away lift DH-REK.10 after more than 30 years of duty, and various upgrades. It is mounted on truck chassis, in front of the rear axle, and is used to **unload or load goods at the side doors** of the truck body.

Unlike many regular fold-away lifts, the DH-SOZ.10 is **suitable for refrigerated bodies** with an insulated floor. It is often used in the **food distribution**, to **deliver frozen or chilled food** product into chain restaurants.

The DH-SOZ.10 is equipped with a double folded platform and a bespoke lift frame construction, to fit within the available mounting space at the side of the truck. In comparison to the former DH-REK.10, this modern slider lift offers a huge improvement in **handling ease, operation and ergonomics**.



**PLATFORM**

- Weight-saving full aluminium platform (base section + foldable point)
- Synthetic rollers for the contact between the platform and the ground
- The folding and unfolding of the platform are assisted by powerful torsion springs

**FUNCTIONAL & MECHANICAL CHARACTERISTICS**

- Very compact slide-away lift, specially designed for side-mounting on truck chassis
- Conical / wedge platform. Level ride with automatic tilt at ground level
- Platform tilt adjustable at any position from the exterior controls

**HYDRAULICAL CHARACTERISTICS**

- 2 lift and 2 tilt cylinders for maximum platform stability
- Electrical safety valves on all cylinders
- Manual emergency operation on all electrovalves
- Cylinder piston rods in hard-chromed stainless steel
- Pump unit 12V or 24V DC, accessible on 5 sides for easy maintenance
- Hydraulic retraction by means of centrally mounted double acting retraction cylinder [OAH023]

**ELECTRICAL CHARACTERISTICS**

- Exterior control box with main battery isolator switch and removable key [OAE030.BT.0]
- Electrical controls without sensitive electronic components
- Safe exterior controls with compulsory 2-hand operation
- Electric motor with thermal cut-out fuse

**FITTING**

- Compact prewelded slide-tube construction, adapted for bolt-on mounting to the truck chassis

**FINISH & MAINTENANCE**

- Low-maintenance bearings in all articulation points, plus grease nipples
- Lift frame in hot-dip zinc plated or "galvanised" finish. Best possible protection against corrosion [OAT104].
- Alu platform or platform sections in natural finish

Disclaimer: data and images of lifts and options are indicative, and may vary in function of the lift execution and vehicle details. Ask confirmation from DHOLLANDIA.



**TECHNICAL CHARACTERISTICS****DH-SOZ.10**

<b>Lift frame</b>	Custom made lift frame, adapted for side mounting on truck chassis
<b>Cylinders</b>	- 2 lift cylinders + 2 fixed stabilizers - 2 tilt cylinders available as option [OAH036]
<b>Retraction in/out</b>	Centrally mounted retraction cylinder
<b>Type of ride</b>	Wedged platform. Level ride + automatic tilt at ground level
<b>Material</b>	Alu / Alu
<b>Standard platform depths</b>	1150 - 1350 mm
<b>Standard platform widths</b>	- 1600 mm - Other widths on request [OAP603]
<b>Lift arm lengths</b>	900 mm
<b>Lift arm widths</b>	700 mm
<b>Standard control unit</b>	OAE030.BT
<b>Standard finish of the lift frame</b>	Hot-dip zinc plated [OAT104]

**MOUNTING DIMENSIONS****DH-SOZ.10**



OAE001 - 2-button wander lead with spiral cable



OAE030.BT.0 - Exterior joystick control box + main battery isolator switch (+ turn switch)

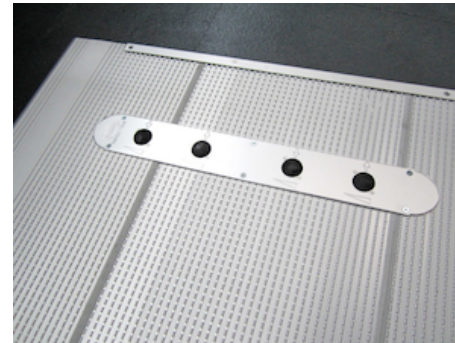

OAE060 - 4-button foot controls in the platform

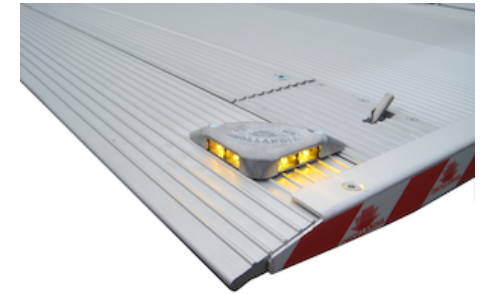

OAE200 - Flashing platform lights



OAE503.1 - Cabin switch (single use)



OAP100.M - 2-piece symm. roll-stops in the platform point - MANUAL

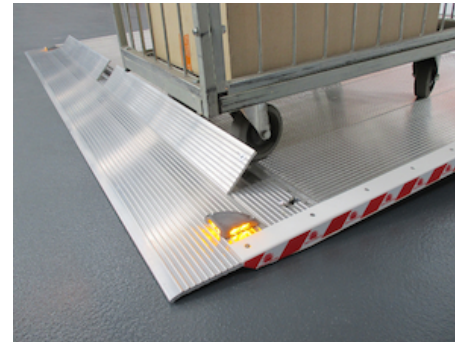

OAP100.A - 2-piece symm. roll-stops in the platform point - AUTOMATIC



OAP601 - Fixed part of folding platform in ALU instead of steel



OAP603 - Non-standard width for foldable platform

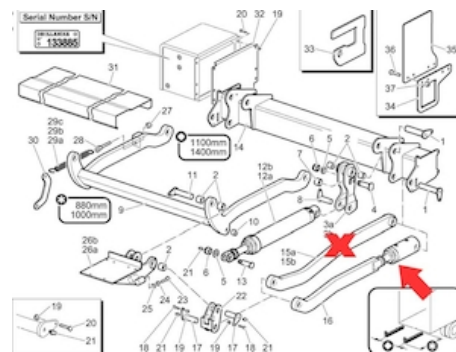

OAH036 - Execution with adjustable platform orientation (tilt cylinders)



OAT020 - Reflecting platform flags type TÜV



OAT023 - Reflecting platform flags type Export Red



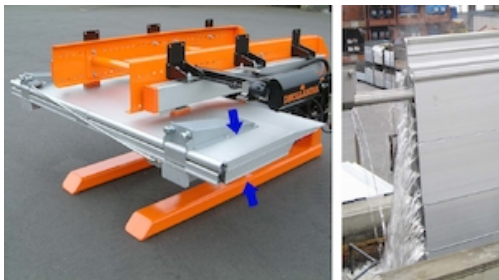

OAT136 - Anodisation alu base section  
+ point DH-S and DH-R



OAU100 - Control box on L side (R  
steering wheel for UK)

